

7030 Series (Male HC Type)

FEATURE :

Insulator Material : PBT UL94V-0 Color : Gray
 Contact Material : Brass
 Board-Lock (Optional) : Brass, 100μ" Tin Plating Min.
 Plating : Selective Gold Plating On Contact Area
 100μ" Tin Plating On Solder Area
 50μ" Nickel Min. Underplating

SPECIFICATION :

Current Rating : 20°C 2A, 70°C 1A, 100°C 0.5A
 Contact Resistance : 30 Milliohms Max. at DC 100mA
 Operation Temperature : -55°C to +125°C
 Dielectric Voltage : AC 1000V For 1 Minute
 Insulation Resistance : 1000 Megaohms Min. At DC500V
 Operating Voltage : 250VAC

ORDERING INFORMATION :

7030 - □□ - □ - □ - □ - □

Board-Lock

N : No Board-Lock
 L : With Board-Lock

Plating

2 : G/F Plating On Contact Area
 8 : 15μ" Gold Plating On Contact Area
 6 : 30μ" Gold Plating On Contact Area

Row / Positions With Contact Type

(See Chart A)

T : Straight Solder Type
 R : Right Angle Solder Type

No. of Contacts

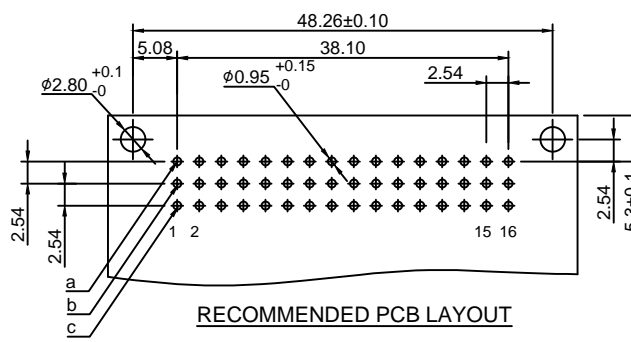
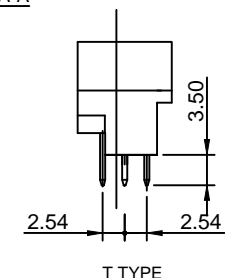
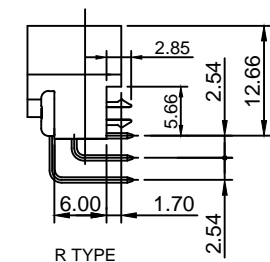
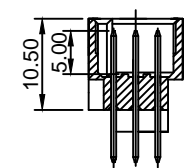
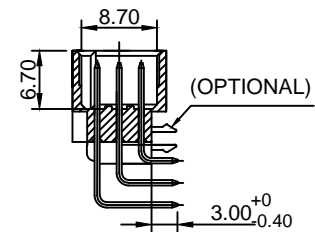
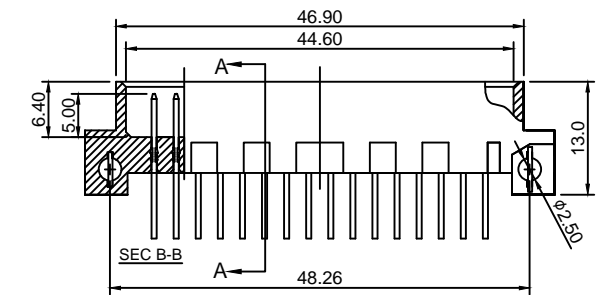
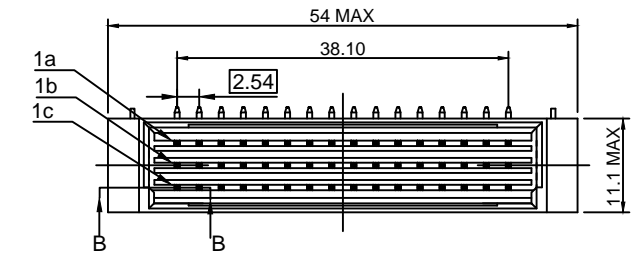

Code	No. of Contacts	Rows / Positions With Contact	Pitch	Code	No. of Contacts	Rows / Positions With Contact	Pitch
G	48	Row a + b + c 	2.54 mm	J	16	Row a 	2.54 mm
H	32	Row a + c 	2.54 mm	K	24	Row a + b + c All Even No. 	5.08 mm Half-Loaded
I	32	Row a + b 	2.54 mm	L	16	Row a + c All Even No. 	

Title : Customer Drawing		Type : DIN 41612 Eurocard		彩電企業股份有限公司 CHARTRON INCORPORATION			
Part No. : 7030 Series HC Type							
Description : 7030 Series Male HC Type				X. ± 0.50 .X ± 0.38 .XX ± 0.25 X.° ± .X° ± .XX° ±			
DWG No. : 010 - 0004 - 703		Date : 01 - Feb. - 2018		Dim. Scale Sheet Rev. mm N/A 1 of 1 D			
APPD. : James C.		CHK. : Connie Z.		DRW. : Bryant C.			